



Georgia Tech | School of City &  
Regional Planning

# Brownfields Area-Wide Planning

A Partnership with the City of Atlanta Brownfields Program

**Nathanael Z. Hoelzel**

PhD Student City and Regional Planning

Co-Instructor, Fall 2012 Planning Studio

School of City and Regional Planning

Georgia Institute of Technology

Atlanta, GA

# School of City and Regional Planning

- 8<sup>th</sup> ranked graduate program in City and Regional Planning (*Planetizen* 2012)
- Celebrating our 60<sup>th</sup> year
  - 1,200 graduates throughout the U.S. and 29 other countries
- Over 20 faculty members
- 100 master's students and 22 PhD students
- Active Student Group and Social Justice Committee

# Overview of Studio



- 2012 fall semester
- Master's students:
  - 10 Georgia Tech
  - 3 Technical University of Kaiserslautern (Germany)
- Instructors:
  - Nancey Green Leigh, PhD, FAICP
  - Nate Hoelzel, PhD student
- Partners:
  - City of Atlanta, BeltLine, Invest Atlanta, U.S. EPA, and Community

# SCaRP is a Community Partner

## Pittsburgh:

Proud History, Bright Future

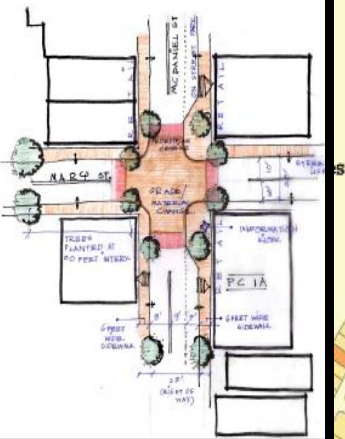

Blueprints for Successful Communities  
Spring 2006



'09 High Point-Joyland Studio



'09 Industrial Studio



'11 Annie E. Casey Site Studio



'11 Fort McPherson Studio

# Studio Outcomes

- **Background Study** (draft by mid-October)
  - Analysis of brownfield impacts and neighborhood conditions
  - Case study of national and international best practices
  - Summary of existing reports, policies, and planning efforts
- **Brownfields Area-wide Plan** (draft by early-December)
  - Vision and policy framework for neighborhood revitalization and brownfield redevelopment
  - Specific strategies for redeveloping priority brownfields
  - Identification of resources and partners
  - Recommendations for next steps
  - Measures of success

# Connections to Previous Planning

- City of Atlanta Comprehensive Plan
- City of Atlanta/Invest Atlanta Redevelopment Plans
- City of Atlanta Brownfield Program
- NPU and other neighborhood master plans
  - *NPUs S, T, V, X, and Y*
- Local non-profit organization projects and plans
- BeltLine Redevelopment and Subarea Master Plans
  - *Subareas 1 and 2*
- Livable Centers Initiatives
  - *Oakland City/Lakewood (2004) and West End (2000)*
- Fort McPherson Redevelopment Plan
- Several Others

# Studio Contributions

- Opportunities for more public and business engagement
- Detailed framework for advancing local planning efforts
- Models for sustainable economic and community development
- Innovative concepts for reusing priority brownfields
- Implementation strategies based on local needs and resources
- Toolkit for overcoming brownfield challenges
- Benchmarks for success and neighborhood indicators
- Resource depository for future efforts

# End – Thank You

## Contact

Nathanael Z. Hoelzel

PhD Student

Georgia Institute of Technology  
School of City and Regional Planning

[natehoelzel@gatech.edu](mailto:natehoelzel@gatech.edu)



## References

Georgia Tech Studios: [http://www.planning.gatech.edu/student\\_research/studios](http://www.planning.gatech.edu/student_research/studios)

Georgia Tech School of City and Regional Planning: <http://www.planning.gatech.edu>